



EN	User manual		2
ES	Manual de usuario		17



 Customer service:

1-800-539-9886
Monday - Friday
8 am to 8 pm, Eastern time
www.dolce-gusto.us

 Servicio al cliente:

1-800-539-9886
Lunes a viernes
8 am a 8 pm, hora del este
www.dolce-gusto.us



EN IMPORTANT SAFEGUARDS

NESCAFÉ
Dolce
Gusto

When using electrical appliances, basic safety precautions shall always be followed, including the following:

1. Read all instructions.
2. Do not touch hot surfaces.
Use handles or knobs.
3. Connect the appliance to outlets with a grounding contact only. Electrical voltage must be 120 V.
4. To protect against fire, electric shock and injury to persons do not immerse cord, plugs or appliance in water or other liquid. Never touch cord with wet hands. Do not overfill water tank.
5. Close supervision is necessary when any appliance is used near children. Keep appliance / power cord / capsule holder out of reach of children. Children should not use the appliance.
6. Unplug from outlet when not in use.
7. Unplug from outlet before cleaning. Allow to cool before putting on or taking off parts, and before cleaning the appliance. Never clean wet or immerse appliance in any fluid. Never clean the appliance with running water. Never use detergents to clean the appliance.
8. After use of the appliance always remove the capsule and clean the capsule holder. Empty and clean drip tray and capsule bin daily.
9. Do not turn off the appliance during descaling process. Rinse the water tank and clean the appliance to avoid any residual descaling agent.
10. Any operation, cleaning and care other than normal use must be undertaken by after-sales service centers approved by NESCAFÉ Dolce Gusto Hotline.
11. In case of intensive use without allowing sufficient cooling time, the appliance will stop functioning temporarily with the red indicator light blinking. This is to protect your appliance from overheating. Switch the appliance off for 30 minutes to let it cool down.
12. Do not operate any appliance with a damaged cord or plug or after the appliance malfunctions, or has been damaged in any manner. Unplug cord immediately. Return appliance to the nearest authorized service facility approved by NESCAFÉ Dolce Gusto Hotline for examination, repair or adjustment.
13. Do not dismantle appliance and do not put anything into openings.
14. The use of accessory attachments not recommended by the appliance manufacturer may result in fire, electric shock or injury to persons.
15. Do not use outdoors.
16. Do not let cord hang over edge of table or counter, or touch hot surfaces or sharp edges. Do not allow cord to dangle (risk of tripping up).
17. Do not place on or near a hot gas or electric burner, or in a heated oven.
18. To disconnect, turn any control to « off », then remove plug from wall outlet. Do not unplug by pulling the cord.
19. Do not use appliance for other than intended use. Appliance is for household use only (non-commercial areas). Appliance must be used in accordance with these instructions and specifications. Use only capsules provided. Liability of manufacturer will be voided due to wrong use for not intended purposes.
20. Always close extraction head with capsule holder. Do not pull out capsule holder before indicator stops blinking.
21. Scalding may occur if the lever is opened during the brewing cycles.
22. Do not put fingers under outlet during beverage preparation.
23. Do not touch the needle of the extraction head.
24. Never carry the appliance by the extraction head.
25. The capsule holder is equipped with one permanent magnet. Avoid placing capsule holder near appliances and objects that can be damaged by magnetism, e.g. credit cards, diskettes and other data devices, video tapes, television and computer monitors with picture tubes, mechanical clocks, hearing aids and loud speakers. Patients with pacemakers or defibrillators: Do not hold capsule holder directly over pacemaker or defibrillator.
26. a) A short power-supply cord is to be provided to reduce risks resulting from becoming entangled in or tripping over a longer cord.

b) Longer extension cords may be used if care is exercised in their use.

c) If a long extension cord is used,

1) The marked electrical rating of the extension cord should be at least as great as the electrical rating of the appliance.

2) If the appliance is of the grounded type, the extension cord should be a grounding-type 3-wire cord, and

3) The longer cord should be arranged so that it will not drape over the counter top or table top where it can be pulled on by children or tripped over.

27. Each capsule is designed to prepare a perfect cup, and cannot be re-used. The capsule should be removed from the machine after extraction.

SAVE THESE INSTRUCTIONS

Packaging is made of recyclable materials. Contact your local council / authority for further information on recycling programs.

Environment protection first!
Your appliance contains valuable materials which can be recovered or recycled.



EN CONSUMER SERVICES

NESCAFÉ
Dolce
Gusto















If you have additional questions, please call our Consumer Service Department. It is helpful to have the product available at the time of your call and to know the reference number that can generally be found on the base of the product.

Phone 1-800-539-9886
Hours Monday – Friday
from 8:00 a.m. – 8:00 p.m. (EST)

Letters should be addressed to:

Nescafé Dolce Gusto
Consumer Services Center
P.O. Box 2178
Wilkes-Barre, PA 18703

Only letters can be accepted at this address. Packages without a return authorization number will be refused.

	Overview	 5
	Rinsing the machine before first use	 6
	Product range	 8
	Preparing a hot beverage	 10
	Cleaning	 12
	Descaling every 3-4 months	 13
	Troubleshooting	 14



EN Overview

NESCAFÉ
Dolce
Gusto

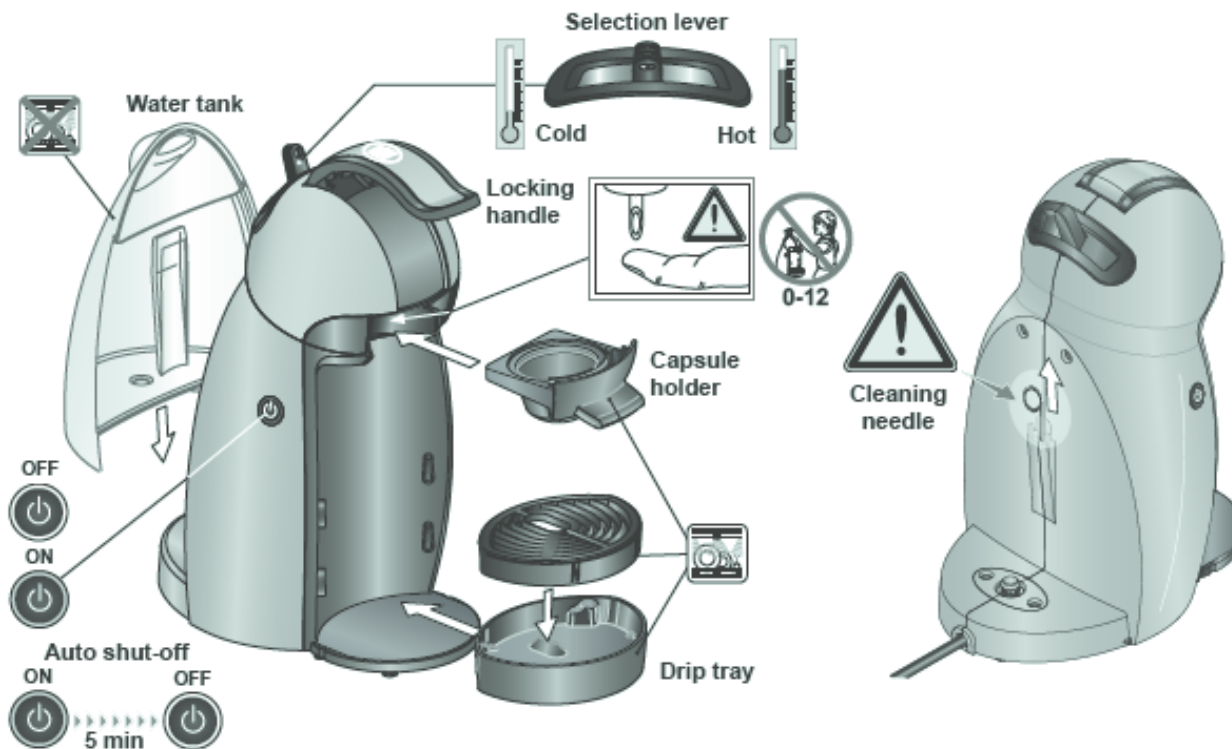

120 V, 60 Hz
max. 1500 W

Pumping pressure max. 15 bar

20.3 oz.
600 ml

5.3 lbs.
2.4 kg

5°C - 45°C
41°F - 113°F

A = 6.3 in. / 15.9 cm
B = 11.3 in. / 28.7 cm
C = 8.7 in. / 22.0 cm

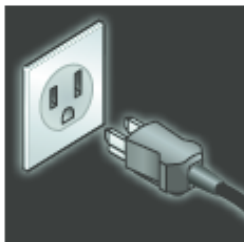

EN Rinsing the machine before first use

NESCAFÉ
Dolce
Gusto

STOP – Please read before using

Your NESCAFÉ® Dolce Gusto™ machine has an auto shut-off function which will automatically turn off the machine after 5 minutes if it is not used. This feature helps you save electricity by reducing the amount of power the machine draws while it is not in use and helps protect the life of your machine. However you can disable this function should you prefer that your machine stays on until you turn it off.

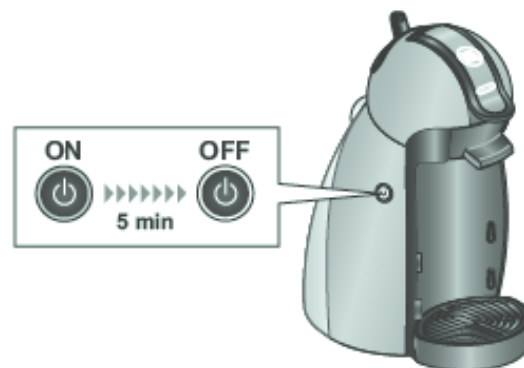

Disable auto shut-off function

When the machine is off, press and hold the power button for 30 seconds until the machine turns off again (ignore light signals and wait until power button is no longer illuminated).

The auto shut-off function is now disabled and the machine will stay on when you next press the power button. You can turn off the machine simply by pressing the power button again.

Unplugging the machine will restore the auto shut-off function.

SHOULD YOU HAVE ANY QUESTIONS OR REQUIRE ANY ASSISTANCE, PLEASE CONTACT THE NESCAFÉ DOLCE GUSTO CUSTOMER SERVICE AT:
1-800-539-9886 (USA)







EN Product range

NESCAFÉ
Dolce
Gusto

Hot Beverage



ESPRESSO



CAFFÈ LUNGO

CAFFÈ LUNGO DECAFFEINATO



CAFFÈ AMERICANO



CAPPUCCINO

CAPPUCCINO SKINNY



MOCHA

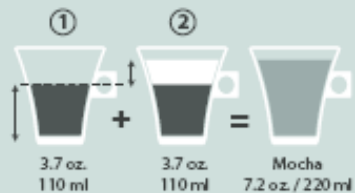
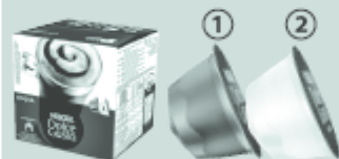

CHOCOCINO

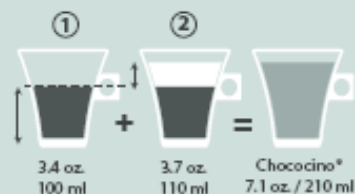
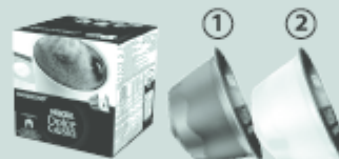

LATTE MACCHIATO



Cold Beverage



CAPPUCCINO ICE



NESTEA PEACH





EN Preparing a hot beverage

NESCAFÉ
Dolce
Gusto

Push power button,
wait until light stops
flashing.

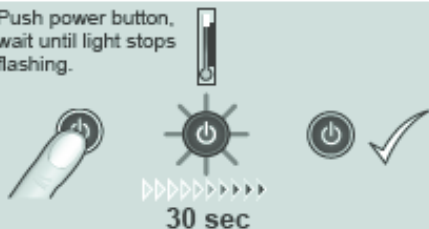

Adjust the drip tray
to the height of your
beverage.

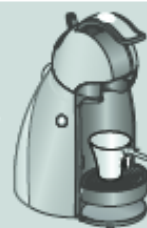

Slide in capsule holder
while locking handle
is up.



Turn lever back to
neutral when your
beverage is to your
liking.



Wait until light stops flashing.



Do not fill tank with hot water.



Locking handle must be closed before moving selection lever.



Do not open locking handle when making a coffee drink.



Wait five seconds after power button has stopped blinking.



Caution!
Do not touch capsules when you remove it from the machine.



EN Economy mode

NESCAFÉ
Dolce
Gusto.

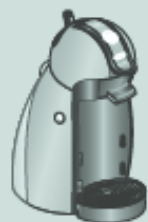

5 min



EN Cleaning

NESCAFÉ
Dolce
Gusto

Daily cleaning



Drip tray

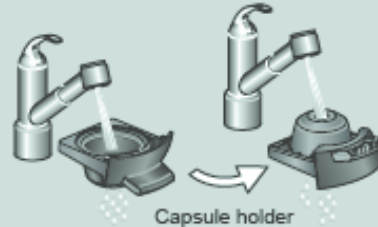

Capsule holder



Water tank



Whenever the machine head is dirty / Weekly cleaning

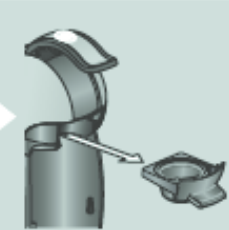
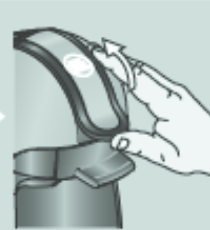

Insert capsule holder without a capsule inside.



Push power button, wait until light stops flashing.



30 sec



~10 sec





EN Descaling every 3-4 months

NESCAFÉ
Dolce
Gusto

Background information

There are minerals such as calcium and magnesium naturally present in most water supplies. High count of solids is referred to as hard water. Scale is the sediment boiled out of the water that eventually coats the internal brewing components of any coffee or espresso machine.

Descaling is critical to the long life of the product. In areas with known high mineral content it's important to descale about once per month. Otherwise every 3-4 months is adequate.

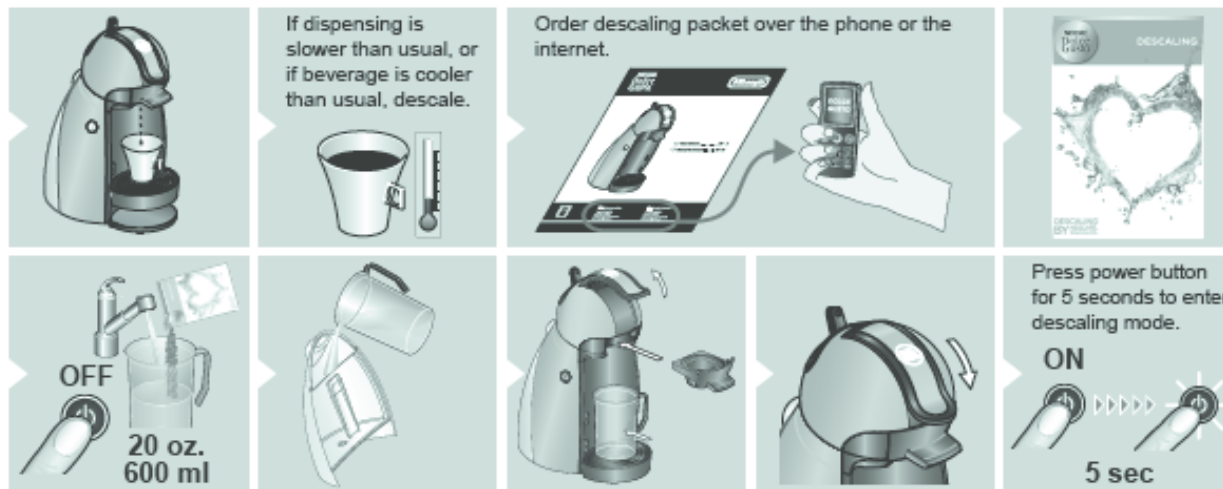

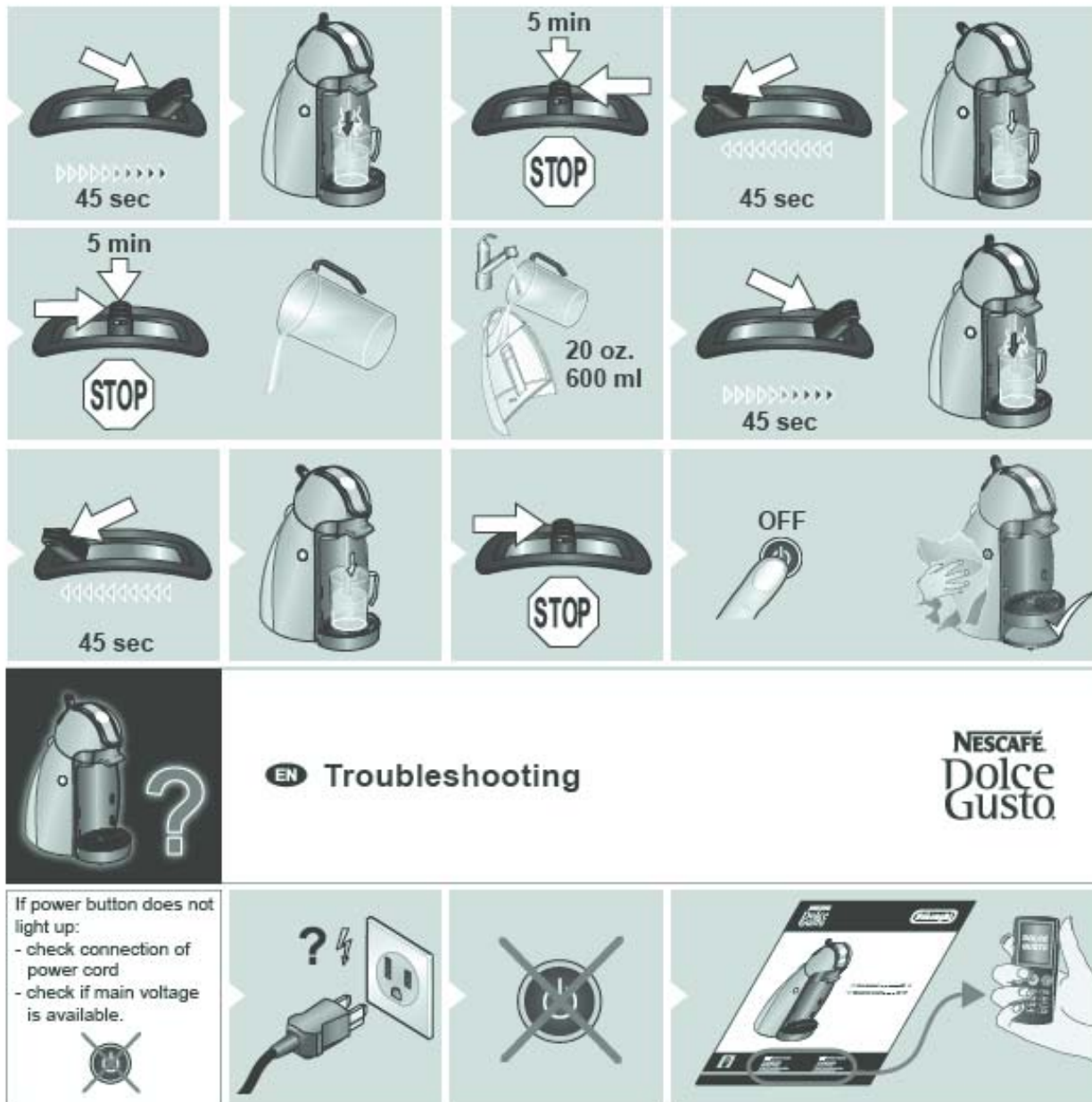

If beverage leaks from the capsule holder, check if the capsule has not been pierced twice.

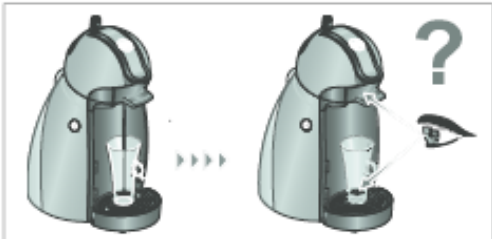
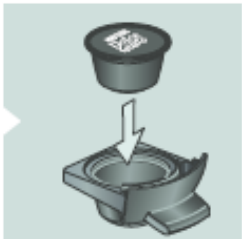

If upon starting the machine you see no flow or the flow suddenly stops, the water may be building up inside the capsule. Stop the machine by turning the selection lever to the neutral position. After 20 minutes lift the locking handle and discard the capsule.



If no liquid comes out when rinsing or descaling: Unblock injector with cleaning needle.





If power button flashes, unplug for 10-15 minutes.
Plug machine back in.
Turn on the machine.
If power button still flashes, call customer service.

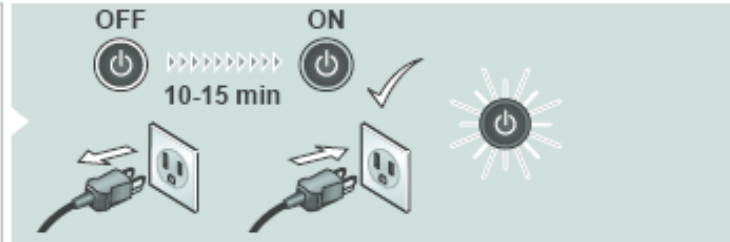

If dispensing is slower than usual, check if the tank is filled and inserted correctly.



If beverage is cooler than usual, descale.



NESCAFÉ.
Dolce
Gusto.

DeLonghi



 Customer service:

1-800-539-9886
Monday - Friday
8 am to 8 pm, Eastern time
www.dolce-gusto.us

 Servicio al cliente:

1-800-539-9886
Lunes a viernes
8 am a 8 pm, hora del este
www.dolce-gusto.us

XXXXXXXXXX